



Esri Public Works & Engineering eBrief



Webinar: Optimizing Field and Fleet Management

To effectively mobilize your field crews and ensure fleet optimization to address community needs, you need the data and insight to understand and manage performance in real time. With GIS, agencies can use field personnel and fleet assets as data collection sensors that feed location-based information into web maps and apps. Attend this webinar on September 27, 2022, to easily understand performance metrics and operations in real time.

[Register Now](#)

Share:   



Street Sweepers, GIS Help North Las Vegas Determine Roadway Improvement Costs

After inventorying its roads, the city built a network schema to show where pavement needed to be replaced and how much it would cost.

[Read Article](#)

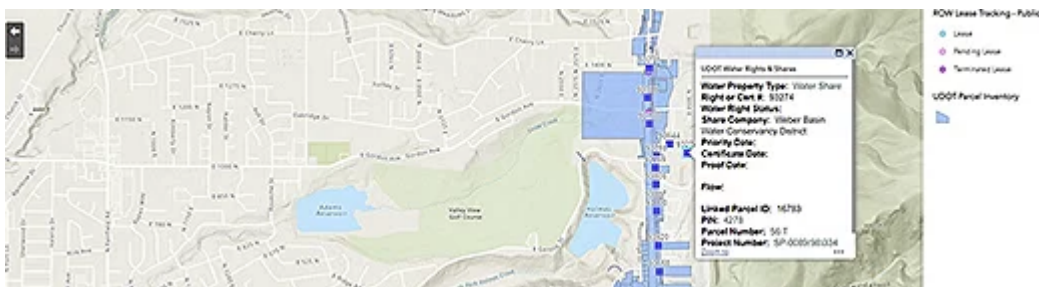

Utah Department of Transportation Gains Multiple Benefits from Managing Its Right-of-Way with GIS

Manual workflows and lack of insight resulted in Utah Department of Transportation (UDOT) repurchasing land it already owned. Now, its right-of-way GIS has allowed the agency to better track and increase its annual surplus property revenue from \$2 million to \$32 million.

[Read Article](#)

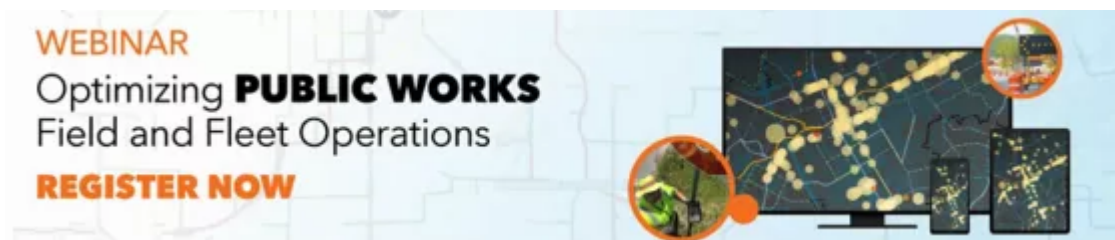

Explore the Latest Public Policy Resources



Broadband Access within Your Community: A Geographic Approach

Explore the digital divide in your city with this broadband exploration app. Learn about access to the internet and how that intersects with various socioeconomic factors within your area.

[Check It Out](#)



Using Maps to Drive Environmental Policy

This recorded workshop from the National Association of Environmental Professionals Conference provides step-by-step guidance on how to use the Esri Maps for Public Policy site in your environmental projects.

[Launch the Recordings](#)

Highlights from the Esri User Conference



City of Sioux Falls Is Creating Innovative Solutions and Experimenting for What Works

With the expected increase in population, city planners must ensure that development proposals contribute to smart growth across the city. Together with engineers from the Public Works Department, the Division of Civic Analytics team can use 3D capabilities to



Massachusetts Department of Transportation Hits the Main Stage at Esri UC

Massachusetts Department of Transportation (MassDOT) developed GeoDOT Local, a geocollaboration hub to connect the state to cities and towns throughout the Commonwealth of Massachusetts, simplifying the process of

map city data above and below ground, visualizing a new perspective.

[Watch the Recording](#)

applying for and distributing infrastructure funds.

[Watch the Recording](#)

More News in Public Works

In the Pipeline with ArcGIS Experience Builder



Using ArcGIS Experience Builder and ArcGIS Dashboards, the City of Renton, Washington, has created a comprehensive portal to streamline the process of compiling and communicating information about the city's surface water infrastructure.

[See More →](#)

The Importance of ARPA Equity

The American Rescue Plan Act of 2021 (ARPA) presented opportunities for communities to further their equity goals. Many are leveraging GIS to understand inequities and prioritize where funding should go.

[Learn More →](#)



INCORPORATE AN EQUITY LENS INTO YOUR WORK

Get the Social Equity Analysis solution today.

[ACCESS NOW](#)

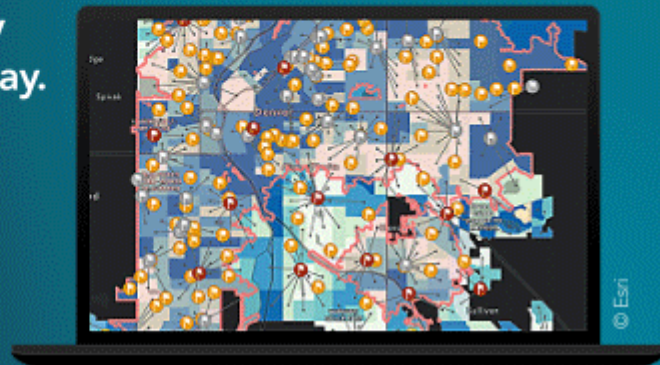

Is your information up to date?

[Update Your Info](#)

[Privacy](#) | [Contact Us](#) | [About Us](#)

Copyright © 2022 Esri. All rights reserved.

Esri, 380 New York Street, Redlands, CA 92373, USA.

